

# CoreStation Series

Future-Ready Intelligent Controller

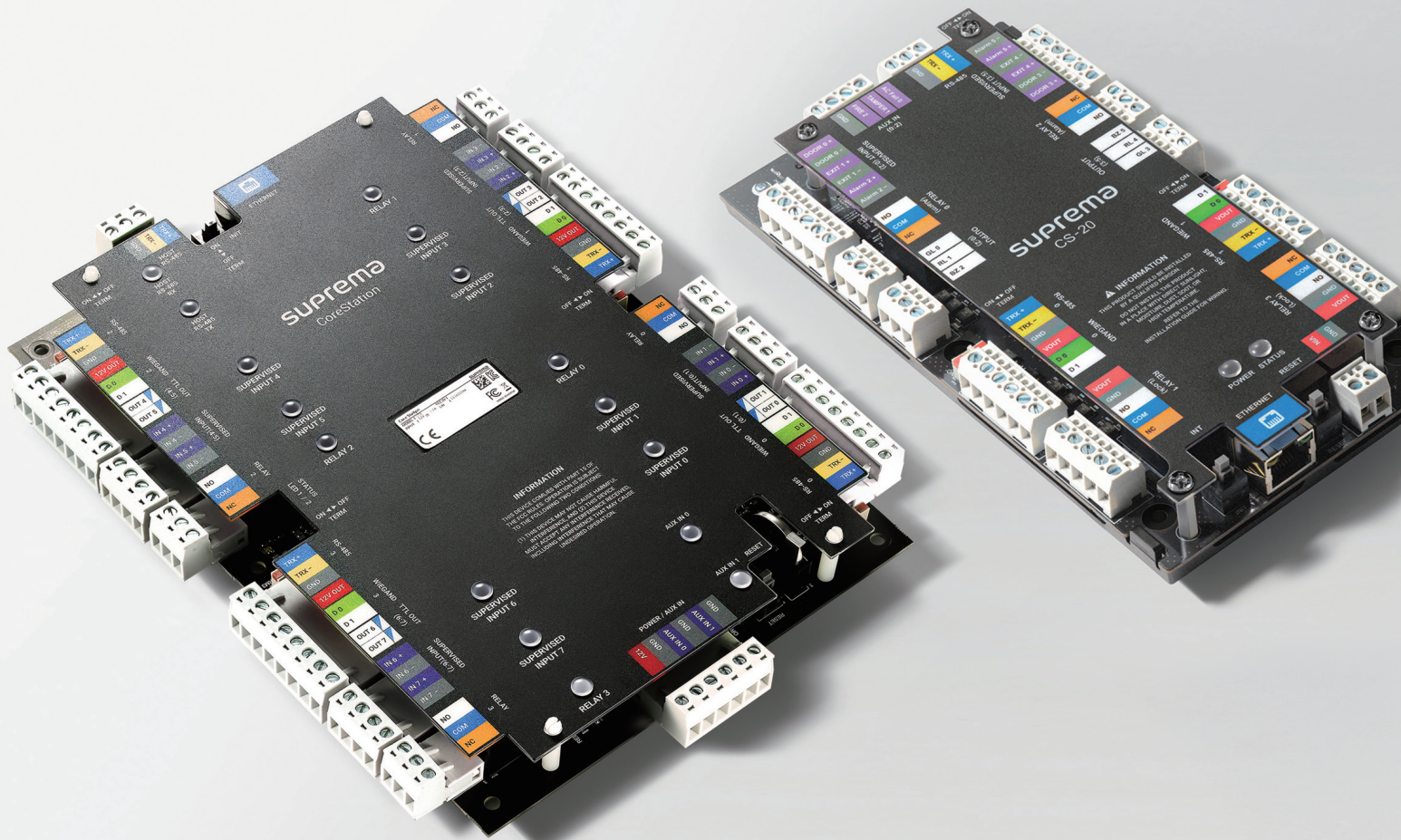

Suprema CoreStation Series sets a new standard in access control by combining centralized intelligence with exceptional versatility. Whether you need advanced fingerprint recognition matching or streamlined card-based access, CS-40 and CS-20 models provide scalable, secure, and future-ready solutions—all powered by the robust BioStar 2 platform. From global enterprises to agile SMBs, CoreStation is the heart of secure infrastructure that grows with you.

**suprema**  
SECURITY & BIOMETRICS



# Key Features

## Centralized Access Control with BioStar 2 Platform

 CS-40 and CS-20/CS-20P operate seamlessly within the BioStar 2 platform, offering centralized management of users, devices, access rights, and logs. This unified system architecture enhances operational efficiency and simplifies scaling.

## High Scalability and Flexible Deployment

 From small offices to enterprise campuses, CoreStation series adapts to various project sizes. CS-40 is ideal for large-scale expansions, while CS-20/ CS-20P provides cost-effective deployment for smaller installations—all under a consistent management platform.

\*Only CS-20P model supports PoE+ and the SAM Slot, enabling simplified installation with a single cable and enhanced security through tamper-resistant smart card authentication.

## Robust Security and Serial Connection Failure Resilience

 All CoreStation models support TLS 1.2 encrypted communication and offline authentication modes, ensuring reliable access control even during serial connection failures. CS-20P also enhances smart card security with a dedicated SAM slot.



# Model Overview

Suprema’s CoreStation series provides centralized access control solutions designed for businesses of all sizes. Whether you require advanced biometric functionality or simple card-based authentication, CoreStation family offers the right fit :

- CS-40: High-security, large-scale systems requiring centralized fingerprint recognition.
- CS-20: Cost-effective, scalable deployments for mid-to-large size facilities with card-based or mobile access.
- CS-20P: Sites requiring secure smart card authentication with SAM Slot, simple deployment, and flexible power options.

# Recommended For

| Model  | Deployment Type   | Recommended Industries   |
|--------|---|--|
| CS-40  | Provide centralized fingerprint recognition and support large-scale system expansion  | National and public institutions, large corporate HQs, airports, critical infrastructure, high-tier data centers, government and defense sites |
| CS-20  | CS-20 is a compact 2-door control system with built-in relays and inputs. It is ideal for simple, cost-efficient installations while offering a scalable access control solution for mid-to-large size facilities using card-based or mobile credentials—ready to meet the demands of enterprise environments | Corporate offices, distribution centers, universities, hospitals, logistics hubs, enterprise buildings without biometric requirement           |
| CS-20P | Features a SAM Slot for secure smart card authentication, simplified deployment, and flexible power options   | Clinics, construction zones, franchise chains, smart retail, temporary/mobile access points, tech-forward SMBs                                 |

## Configuration | CS-40

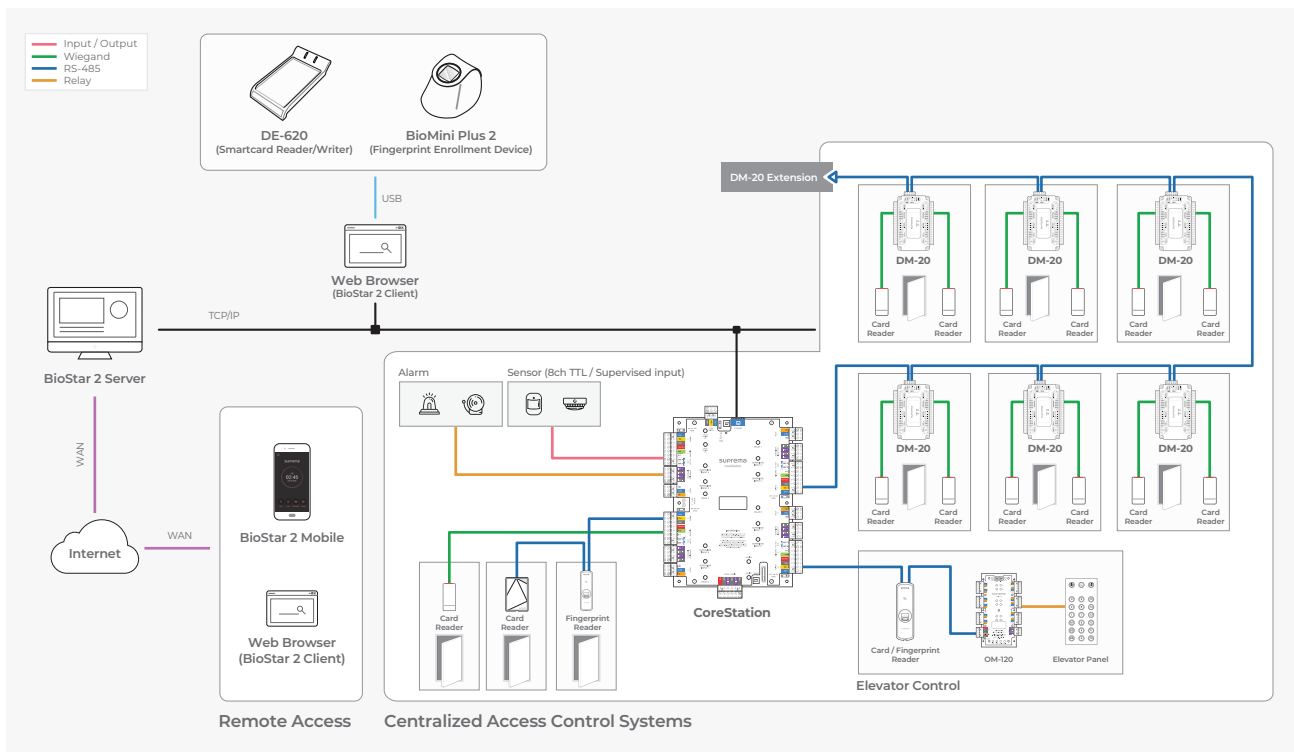

## Configuration | CS-20/CS-20P

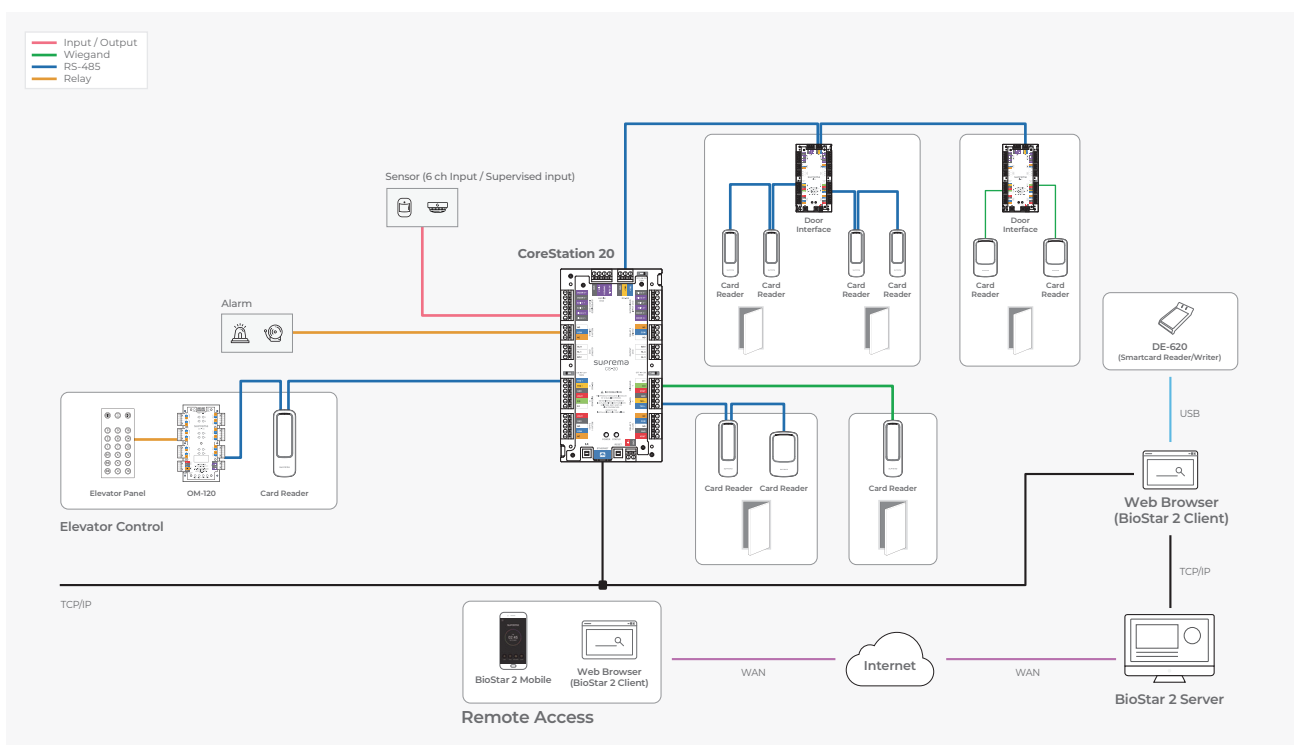

## Specifications

| Category                      | CS-40   | CS-20   | CS-20P  |
|-------------------------------|---|---|---|
| Product                       |  |  |  |
| Max. User                     | 500,000 <sup>(1)</sup>  | 500,000   |   |
| Max. Credential (1:N)         | Face: 4,000 <sup>(2)</sup>  | -   |   |
| Max. Credential (1:1)         | Face: 30,000 <sup>(2)</sup><br>Card: 500,000<br>PIN: 500,000                      | Card: 500,000<br>PIN: 500,000   |   |
| Max. Text Logs                | 5,000,000   | 5,000,000   |   |
| Ethernet                      | 10/100 Mbps, Auto MDI/MDI-X   | 10/100 Mbps, Auto MDI/MDI-X   |   |
| RS-485                        | 5 ch  | 3 ch  |   |
| RS-485 Communication Protocol | OSDP V2 compliant   | OSDP V2 compliant   |   |
| Wiegand                       | 4 ch  | 2 ch  |   |
| Relay Output                  | 4 (via module)  | 4 built-in  |   |
| Supervised Input              | 8 ch <sup>(3)</sup>   | 6 ch <sup>(3)</sup>   |   |
| AUX Input                     | 2 ch (Power Fail, Tamper)   | 3 ch (Power Fail, Tamper, Fire)   |   |
| SAM Slot                      | -   | -   | Supported   |
| Max. Slave Devices (RS-485)   | 64 (max 31/port)  | 4 devices   |   |
| Max. Wiegand Devices          | 132 (with DM-20)  | 2   |   |
| CPU                           | 1.4 GHz Octa Core   | 1.2 GHz Single Core   |   |
| Memory                        | 8 GB Flash + 1 GB RAM   | 4 GB Flash + 256 MB RAM   |   |
| Crypto Chip                   | Supported   | Supported   |   |
| LED                           | Multi-color   | Power: Red, Status: Multi-Color   |   |
| Operating Temperature         | 0°C ~ 50°C (32°F ~ 122°F)   | 0°C ~ 50°C (32°F ~ 122°F)   |   |
| Tamper                        | Optional (ENCR-10)  | -   |   |
| Power                         | 12 VDC/24 VDC, Max 0.2A/0.1A  | 12 VDC/24 VDC, Max 2.8A/1.4A  |   |
| Dimensions (W x H x D mm)     | 150 x 214 x 21  | 100 x 190 x 33.9  |   |
| PoE+                          | -   | -   | Supported   |
| Certifications                | CE, UKCA, KC, FCC, RCM, RoHS, REACH, WEEE, ETL Listed to UL 294                   | CE, UKCA, KC, FCC, RCM, IC, RoHS, REACH, WEEE, EAC                                  |   |

(1) The number of users registered without any credential data.

(2) FaceStation 2 and FaceLite are available only.

(3) Input or Supervised Input selectable.

- If CoreStation is a master device and a device with a fingerprint sensor is connected as a slave, the slave device can be used for fingerprint authentication.
- Max. Fingerprint Credentials (1:N): 100,000 / Max. Fingerprint Credentials (1:1): 500,000



### Suprema Inc.

17F Parkview Tower, 248, Jeongjail-ro, Bundang-gu, Seongnam-si, Gyeonggi-do, 13554, Republic of Korea

T +82 31 783 4502 W [www.supremainc.com](http://www.supremainc.com)



For more information visit our website below by scanning the QR code.  
<https://www.supremainc.com/en/about/contact-us.asp>